

# BELLOW SEALED GLOBE VALVE

## TYPE 3562 PN16



### GENERAL

DIMENSION:	DN15 TO DN200
PRESSURE:	PN16
TEMPERATURE:	-10°C TO 300°C
(PRESSURE AND TEMPERATURE ARE INTERDEPENDENT)	
CONNECTION:	FLANGES EN 1092-1 TYPE B
MATERIAL:	CAST IRON AND STEEL
FACE TO FACE:	EN 558-1

### OPTIONS

PRESSURE:	PN16 (DUCTILE IRON - MAX. 350°C) PN25 (DUCTILE IRON - MAX. 350°C) PN40 (STEEL - MAX. 400°C)
DISC:	FOR FLOW CONTROL

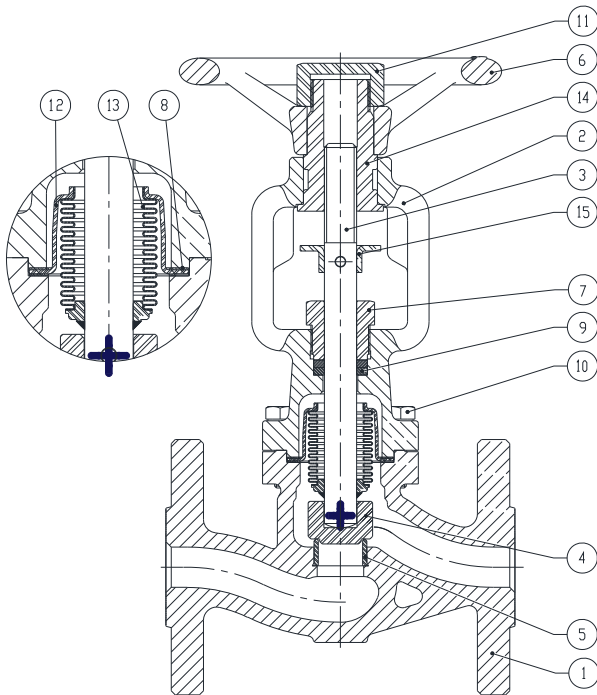

POS	DESCRIPTION	MATERIAL
1	BODY	CAST IRON EN-GJL250
2	BONNET*	STEEL 1.0619
3	STEM	STAINLESS STEEL
4	PLUG	STAINLESS STEEL
5	SEAT	STAINLESS STEEL
6	HANDWHEEL	DUCTILE IRON EN-GJS400
7	GLAND NUT	ZINC PLATED
8	GASKET	GRAPHITE
9	PACKING	GRAPHITE
10	BOLTS	ZINC PLATED
11	HANDWHEEL NUT	ZINC PLATED
12	HOOD	STAINLESS STEEL
13	DOUBLE BELLOW	TITANIUM 1.4571
14	BUSHING	STEEL
15	ANTI TURN DEVICE	ZINC PLATED

\*) DN65 - DN200: Cast iron EN-GJL250

### DESCRIPTION

- **High quality bellows sealed globe valve**, with double titanium bellows. The bellows are welded onto the stem and hood, and also act as the joint gasket between body and bonnet. This type of stem packing is sublime which makes this valve suitable for steam and hot oil applications.
- **Operating the hand-wheel** ensures a calm opening of the valve, which prevents steam- and water-hammering in the pipes.
- **Valves in cast iron PN16** are held in stock, whereas valves in ductile iron and steel are available on request.
- **For use as a control valve** and an even softer opening, the valve may be fitted with a soft cone, which gives a more linear flow characteristic.
- **A long life-time** without maintenance may be expected of this high-quality bellows sealed globe valve.
- **Graphite rings** are mounted as a secondary stem packing, in the unlikely event of a bellows leakage.
- **Steam at 200°C or 10 bar** are the limit in DK for valves in cast iron. Above these conditions, valves in ductile iron or steel are chosen.

## DIMENSIONS

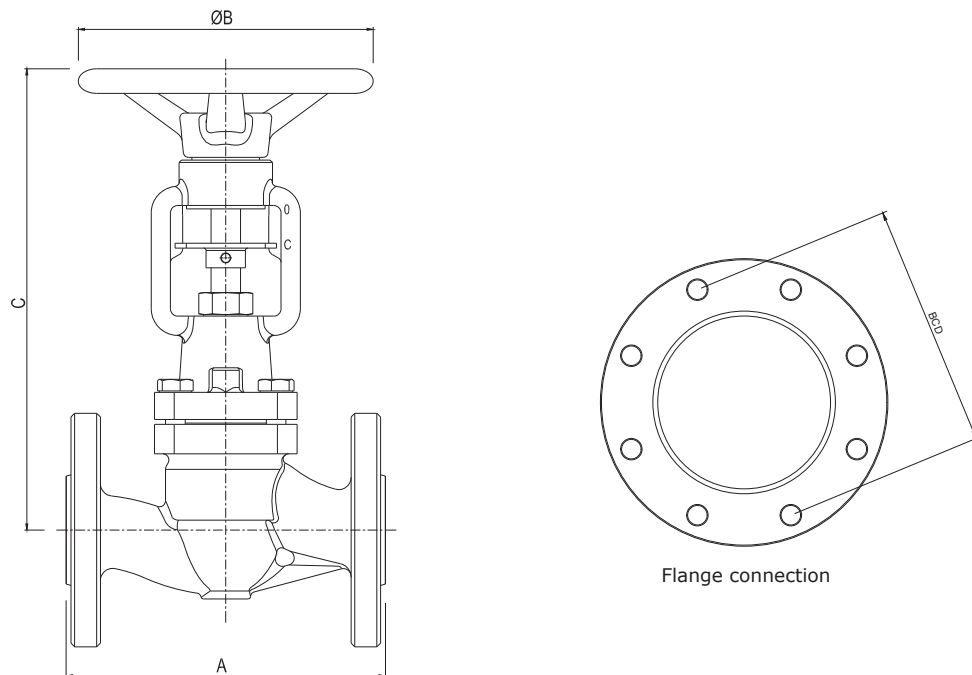

DIM	DIMENSIONS [MM]			FLANGE DIMENSIONS PN16 [MM]		WEIGHT [KG]
	A	C	ØB	Holes	BCD	
DN15	130	190	120	4 x M12	65	3.2
DN20	150	195	120	4 x M12	75	4.4
DN25	160	220	140	4 x M12	85	4.8
DN32	180	219	140	4 x M16	100	6.1
DN40	200	256	180	4 x M16	110	11.0
DN50	230	265	180	4 x M16	125	13.0
DN65	290	328	200	4 x M16	145	21.0
DN80	310	341	200	8 x M16	160	26.4
DN100	350	376	250	8 x M16	180	40.0
DN125	400	488	275	8 x M16	210	53.5
DN150	480	531	275	8 x M20	240	81.0
DN200	600	685	400	8 x M20	295	154.0

## PRESSURE / TEMPERATURE

## DATA

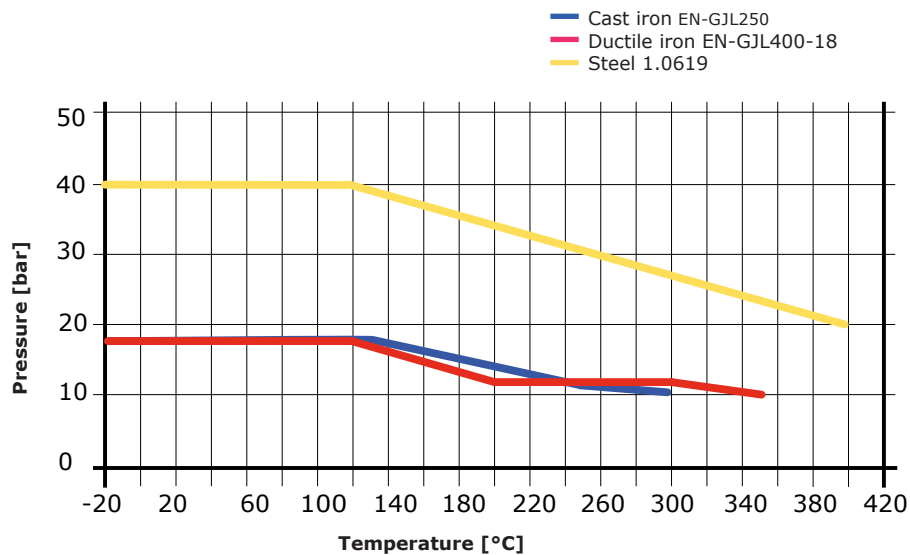

DIM	Kv
	[m <sup>3</sup> /h]
DN15	3.8
DN20	7.0
DN25	10.0
DN32	19.0
DN40	35.0
DN50	43.0
DN65	60.0
DN80	110.0
DN100	146.0
DN125	210.0
DN150	300.0
DN200	670.0